

# Township 1 North Range 45 West Yuma County, Colorado

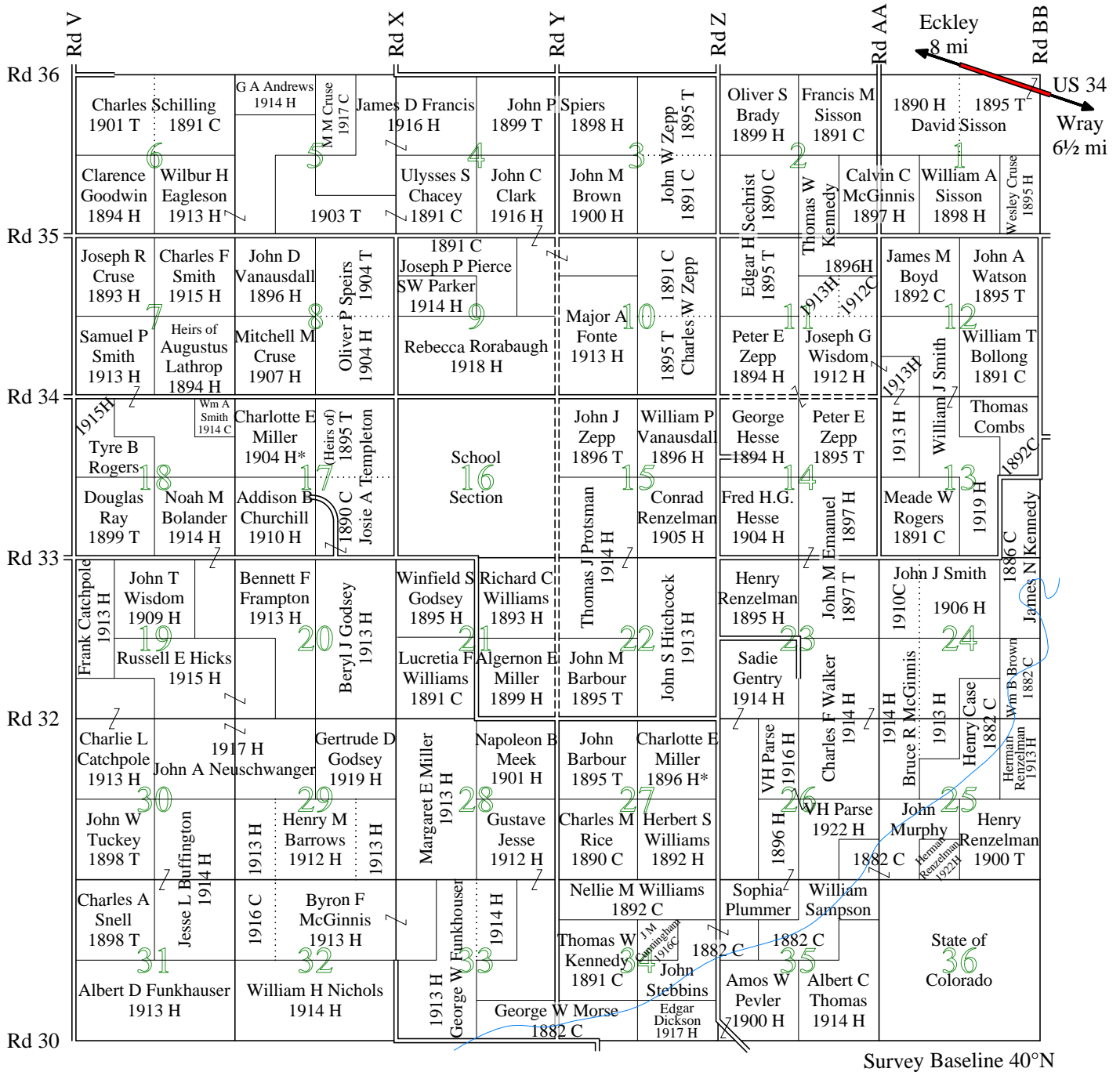

Type of Patent
C- Cash Sale
H- Homestead Act
T- Timber Culture

Township Map  
Original Land Patents  
© 2003 Marion D. Monk and Lee C. Zion

Index to Names of Original Land Patent Holders  
Township 1 North Range 45 West  
Map © 2003 Marion D. Monk and Lee C. Zion

<u>Patent Holder</u>	<u>Section</u>	<u>Patent Holder</u>	<u>Section</u>
Andrews, George A	5	Miller, Algernon E	21
Barbour, John	27	Miller, Charlotte E*	17, 27
Barbour, John M	22	Miller, Margaret E	28
Barrows, Henry M	29	Morse, George W	33, 34
Bolander, Noah M	18, 19	Murphy, John	25, 26
Bollong, William T	12	Neuschwanger, John A	29, 30
Boyd, James M	12	Nichols, William H	32
Brady, Oliver S	2	Parker, Steven W	9
Brown, John M	3	Parse, Victoria H	26
Brown, William B	24	Pevler, Amos W	35
Buffington, Jesse L	30, 31	Pierce, Joseph P	9
Case, Henry	24, 25	Plummer, Sophia	26, 35
Catchpole, Charlie L	19, 30	Protsman, Thomas J	15, 22
Catchpole, Frank D	19	Ray, Douglas	18
Chacey, Ulysses S	4, 5	Renzelman, Conrad	15
Churchill, Addison B	17	Renzelman, Herman	25
Clark, John C	4, 9, 10	Renzelmann, Henry	23, 25
Combs, Thomas	13	Rice, Charles M	27
Cruse, Joseph R	7	Rogers, Meade W	13
Cruse, Mitchell M	5, 8	Rogers, Tyre B	18
Cruse, Wesley	1	Rorabaugh, Rebecca	9
Cunningham, James M	34	Sampson, William	35
Dickson, Edgar	34	Schilling, Charles	6
Eagleson, Wilbur H	5, 6	Sechrist, Edgar H	2, 11
Emanuel, John M	14, 23	Sisson, David	1
Fonte, Major A	10	Sisson, Francis M	2
Frampton, Bennett F	20	Sisson, William A	1
Francis, James D	4, 5	Smith, Charles F	7
Funkhauser, Albert D	31	Smith, John J	24
Funkhouser, George W	33	Smith, Samuel P	7, 18
Gentry, Charles A*	23, 26	Smith, William A	18
Gentry, Sadie	23, 26	Smith, William J	12, 13
Godsey, Beryl J	20	Snell, Charles A	31
Godsey, Gertrude D	29	Speirs, John P	3, 4
Godsey, Winfield S	21	Speirs, Oliver P	8
Goodwin, Clarence	6	Stebbins, John	34, 35
Hesse, Fred H G	14	Templeton, Jodie A	17
Hesse, George	14	Templeton, Josie A Heirs	17
Hicks, Russell E	19, 20	Thomas, Albert C	35
Hitchcock, John S	22	Tuckey, John W	30
Jesse, Gustave	28, 33	Vanausdall, John David	8
Kennedy, James N	13, 24	Vanausdall, William P	15
Kennedy, Thomas W	2, 11, 34	Walker, Charles F	23, 26
Lathrop, Augustus Heirs	7	Watson, John A	12
McGinnis, Bruce R	24, 25	Williams, Herbert S	27
McGinnis, Byron F	32, 33	Williams, Lucretia F	21
McGinnis, Calvin C	1, 2	Williams, Nellie M	34
Meek, Napoleon B	28	Williams, Richard C	21

<u>Patent Holder</u>	<u>Section</u>
Wisdom, John T	19
Wisdom, Joseph G	11, 12, 13
Zepp, Charles W	10

<u>Patent Holder</u>	<u>Section</u>
Zepp, John J	15
Zepp, John W	3
Zepp, Peter E	11, 14

**Notes:**

1. The Gentry patents were issued to "Sadie Gentry; widow of Charles A. Gentry."

2. Unless there were two Charlotte E. Millers, the BLM database has either the 1904 Homestead in section 17 or the 1896 Homestead in section 27 coded incorrectly.

3. This map shows the "Jodie A." and "Josie A." Templeton patents in section 17 as issued to Josie A. Templeton.